

COR-A-VENT® continues its tradition of being the Leader in Innovative Rooftop Ventilation® with the latest addition to its extensive roof and siding ventilation product lineup, NEW Roof-2-Wall Vent™.

Roof-2-Wall Vent does just what it says – it's a ventilation package for the tough-to-vent detail where a pitched roof meets a vertical wall. Roof-2-Wall Vent incorporates the Active Weather Foil technology and enhanced snow screen feature of our X-5 ridge vent line to stop rain and snow at the point of entry. COR-A-VENT® continues its tradition of being the Leader in Innovative Rooftop Ventilation® with the latest addition to its extensive roof

and siding ventilation product lineup, NEW Roof-2-Wall Vent™. Roof-2-Wall Vent does just what it says – it's a ventilation package for the tough-to-vent detail where a pitched roof meets a vertical wall. Roof-2-Wall Vent incorporates the Active Weather Foil technology and enhanced snow screen feature of our X-5 ridge vent line to stop rain and snow at the point of entry.

Provides 8.5 sq. in. NFVA

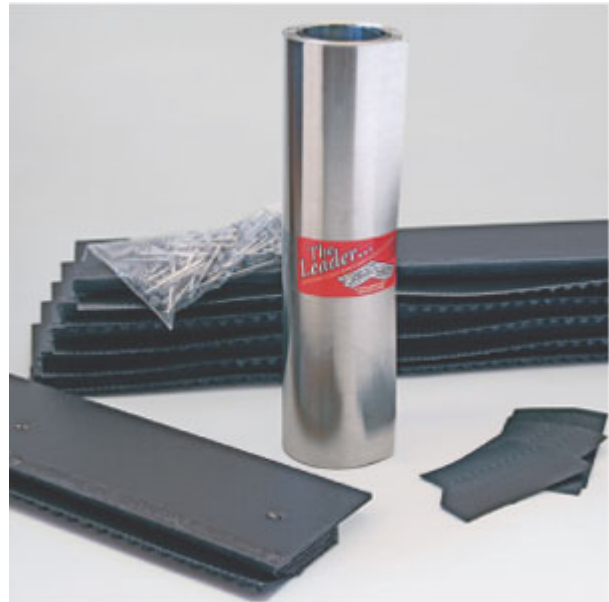

INSTALLATION IS EASY — it's all in the box! Each carton contains six 4-foot pieces (24 lineal ft.) of Roof-2-Wall Vent, a 25-foot long x 14-inch wide roll of flashing, one bag of 2 1/2" nails and four EC-400 Roof-2-Wall end caps.

Installation Instructions

One person can easily install the handy four-foot Roof-2-Wall sections. All you need is a hammer, circular saw, chalk line, utility knife, tape measure and a caulking gun. These instructions are typical for a standard shingle roof application or call our technical dept. for advice on your specialized application, or send us a print and we'll "mark up" where and how to vent it.

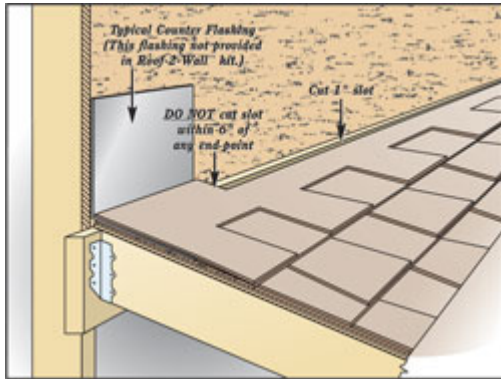

Step 1: Start by cutting 1" wide clear slot in roof deck at or near the top. Stop slot no less than 6" from the ends of the roof section to be ventilated.

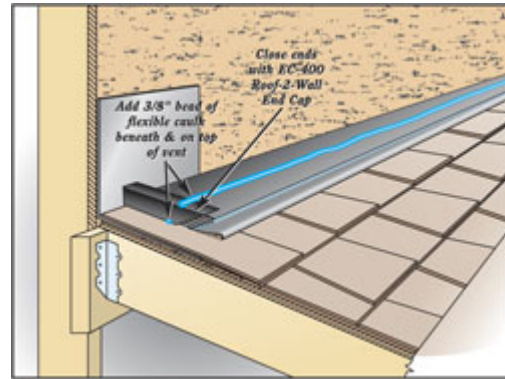

Step 2: Apply 3/8" bead of flexible caulk (NOT roofing cement) beneath Roof-2-Wall™ Vent pcs. and nail down with 2 1/2" nails provided*. Run vent at least 6" past slot in decking and close off ends with EC-400 Roof-2-Wall End Caps provided. Use a flexible caulk to seal all seams, then run another 3/8" bead of flexible caulk along the top of all vent pcs.

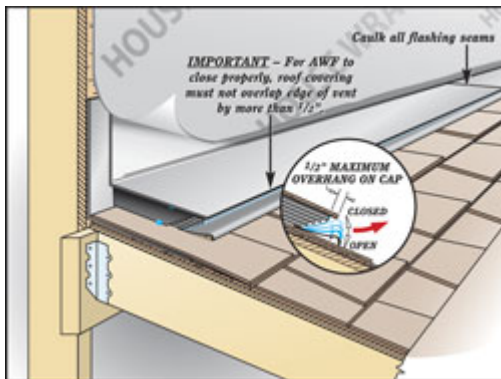

Step 3: Use Roof-2-Wall flashing provided to cover vent, up onto wall. Nail flashing securely to the wall and overlap flashing with housewrap or felt paper/water-proof membrane.

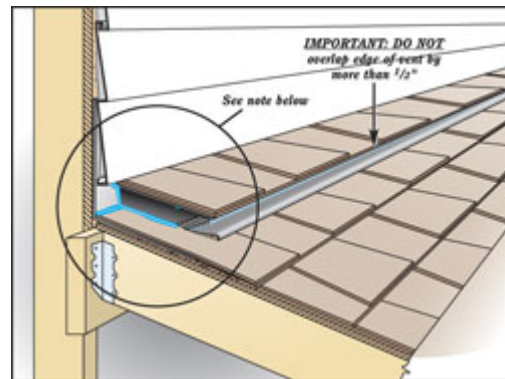

Step 4: Cap or cover Roof-2-Wall assembly with shingle tabs or heavy-gauge/decorative metal cap. Be sure to caulk all ends and joints to ensure a water-tight installation.

A minimum 3/12 roof pitch is required for Roof-2-Wall application.

NOTE: Installer is responsible for sealing ends of vent for each specific application.

Due to the wide variety of material choices and possible installation options, it is the installer's responsibility to seal the vent assembly's ends with appropriate method and materials to prevent weather infiltration.

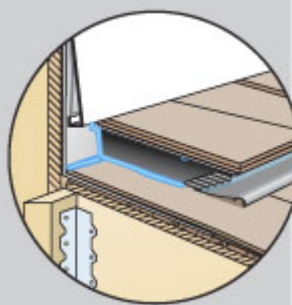

* Be sure to use nails long enough to penetrate vent and roof deck. Heavyweight, architectural and re-roof installations may require a longer nail than the 2 1/2" ones provided.

CORAVENT
A Trusted Name in Attic Ventilation Since 1976®